



# EXTERIOR CLADDING

Commercial & Residential  
Building Inspections & Indoor Air Quality Testing

Exterior Cladding is a building covering / sheathing system usually applied to provide desirable surface properties, such as, durability, weathering, corrosion or impact resistance. The fundamentals of cladding are

- The building envelope should be water resistant and openings should be waterproof;
- Exterior walls should be covered with approved materials designed and installed to provide a barrier against the weather and pests to enable environmental control of the interior spaces.

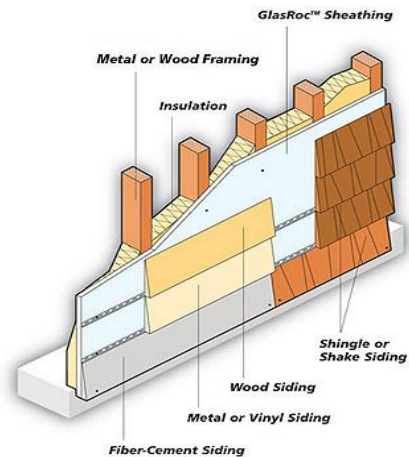

## Some Types of cladding include:

- Stucco
- EIFS – Exterior Insulation Finish System
- Masonry Veneer
- Cement Board
- Wood or Wood Products
- Vinyl and Metal Siding

## Common Defects Found in Cladding

- Poor Workmanship / Material Defects
- Temperature – Expansion and Contraction
- Pest Intrusion
- Moisture
- Ultra-Violet Radiation

